

INSTRUCTIONS FOR FLAT, SKILLION AND GABLE ROOF SHEDS & AVIARIES

SLAB DIMENSIONS FOR GARDENSTAR SHEDS

Shed Size		Slab Size	No. Anchors
Side	End (Flat, Skillion, Gable)		
1.5 x	0.78m	1570 x 850mm	4
1.5 x	1.5 m	1570 x 1570mm	6
2.25 x	1.5 m	2320 x 1570mm	6
3.0 x	1.5 m	3070 x 1570mm	8
3.75 x	1.5 m	3820 x 1570mm	8
1.5 x	1.8 m	1575 x 1870mm	6
2.25 x	1.8 m	2320 x 1870mm	6
3.0 x	1.8 m	3070 x 1870mm	8
3.75 x	1.8 m	3820 x 1870mm	8
2.25 x	2.25m	2320 x 2320mm	8
3.0 x	2.25m	3070 x 2320mm	10
3.0 x	3.0 m	3070 x 3070mm	10
3.75 x	2.25m	3820 x 2320mm	10
3.75 x	3.0 m	3820 x 3070mm	12
3.75 x	3.75m	3820 x 3820mm	12

For details on how to rebate your slab, visit www.gardenstar.com.au

IMPORTANT NOTES

- Do not attempt to install shed in windy weather**
- To prevent serious injury gloves must always be worn when handling steel sheet
- The site for the shed or aviary must be level. We strongly recommend that sheds are installed onto a concrete base.
- Sheds installed without adequate anchoring to timber or concrete base could be extensively damaged in windy weather. GARDENSTAR timber and concrete anchor kits are available through your retailer.
- Packet of self-tapping screws supplied with shed. If desired, pop rivets (1/8", 3.2mm) or tek screws (10x16mm) may be used instead.
- When installed, ribs in sheeting face outwards for all panels.
- Remove all metal swarf immediately after installation, or rust staining may occur. Please note that damage caused to the steel by chemicals inc. pesticides & herbicides is not covered by the guarantee. View the guarantee at www.gardenstar.com.au or call **1800 656 771**

TOOLS REQUIRED

Electric drill

No. 30 (1/8") drill bit (preferably panel drill "Shorty" or "Stubby")

Philips screwdriver

Pliers

IDENTIFICATION OF PANELS

- Front:** With door. Has cut-out sections in channel at each corner to accept side panels.
- Back:** Same size as front. Also has cut-out sections.
- Ends:** **For flat roof shed:** two 1.5m panels.
For skillion roof shed: one left hand panel, and one right hand panel.
For gable roof: two gable end panels.
- Roof:** **For flat roof:** a plain panel same length as back but has flashings along the ends.
For skillion roof shed: as for flat roof shed.
For gable roof shed: two plain panels with flashing, same length as back, and a ridge beam.
- Window:** If ordered with shed, one wall panel will have cut-out to receive window frame supplied. Pack of 5 sheets of glass included

ERECTING THE WALL PANELS

- Place back panel in position and fit one side only into place, nesting it into cut-outs at top and bottom. It may be necessary to bend the cut-out channel ends open a little to accept the side wall. Set the shed walls at more than 90° while drilling and fixing. This gives a tight finish when squared up.
- From the outside drill through the overlap at the corner and drive self-tapping screws firmly home, (see sketch). Use a minimum of five screws (or rivets), evenly spaced, for each corner.

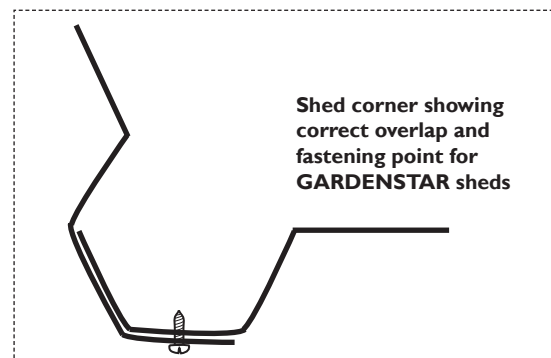

- Repeat Step 4 for the second side.
- Bring front (door) panel up to side walls and fasten each corner as before. The four walls are now securely fastened.

FIXING THE ROOF

5. **Flat and Skillion Roof** - Roughly square the walls and lift the roof on, allowing desired overhang front and back. Drill through roof flashing and top wall channel on one end of the shed and drive screws firmly home. Space at 500mm intervals. Square the shed by checking that the roof overhang is even along the front. Fasten roof to front and back wall channels at 500mm intervals. Check that wall is straight before commencing to drill. Screw self-tappers down from top.

Gable Roof— Lie ridge beam upside down on the ground. Slide one roof panel (also upside down) into ridge beam as directed by arrows on flashing. Make sure roof panel is pushed fully into slot. Drill and fix through beam into roof channel at 750mm intervals. Lift panel into position on walls so that ridge beam rests directly over apex of gable walls. Drill and fix roof panel to sides and front (or back) as described for flat roof shed. Finally, slide other roof panel into its slot in ridge beam, and repeat fixing procedure. Drilling through the ridge beam to attach second roof panel is done from inside shed.

6. Bend in the ends of roof flashing at each corner to eliminate sharp corners.

ADJUSTMENT OF DOOR BOLT

7. If the site is not quite level, as often happens, the padbolt may not slide easily into the hasp. This may be adjusted by levering up the wall and packing beneath it, either immediately below the bolt or immediately below the hinges. A trial will soon show which is required. This adjustment should be made before final anchoring of the front panel to ground or concrete.

FIXING A FIVE BLADE LOUVRE WINDOW

8. Place window frame in the cut-out with the larger skirt to the top, line up edge of the frame with all ribs and drill and fix on the sides and along the bottom. Insert glass from inside the shed.

FIXING 'BIRD PROOFING' TO AVIARY

9. These pre-shaped strips are fixed to the top of wall, inside the unit, to block the spaces formed by the ribs of the roof sheeting. Two screws per length of 750mm 'bird proofing', is sufficient.

ANCHORING YOUR INSTALLATION

10. It is essential to firmly anchor the shed as soon as erection is completely, otherwise there is risk of damage by wind.

Timber base

Units may be fastened to a timber floor using anchor brackets and coach screws. It is essential that the floor is secured to concrete or timber piers firmly embedded in the ground.

Concrete base

Recommended Method:

A concrete slab with a stepped edge as illustrated opposite will prevent rain water from trickling under the wall of the shed. For further details on how to rebate your slab, visit www.gardenstar.com.au or call **1800 656 771**.

Method 1: Sheds may be anchored to the ground and a concrete slab poured inside. If this method is used, it is advisable to line the lower section of the wall with building plastic film (such as Fortecon) to prevent the wet concrete coming in direct contact with the steel panel. This can be taped against the wall above the required floor level, and trimmed neatly when the concrete has cured.

Method 2: Sheds may be fixed to an existing concrete slab using a Gardenstar concrete fixing kit (Anchor brackets and bolts). The correct size masonry drill necessary for the masonry bolts supplied is 8mm diameter.

NOTE : Spacing between anchors should not exceed 1500mm

LAYOUT FOR CONCRETE WITH REBATED EDGE

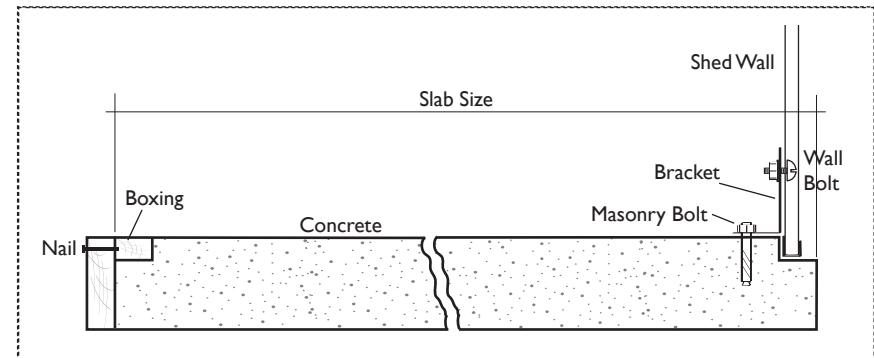

Manufactured by:
SOUTHLAND INDUSTRIES
98 GORMANSTON ROAD, (PO Box 399)
MOONAH TAS 7009
T: (03) 6272 1477 FREECALL 1800 656 771